

Items	Details
Name	VGOD 200W
Model	VGELITE200-A
Material	Aluminum Chassis, Stainless Steel, Anodized Paint
Weight (g) ex.batteries	~ 375g
Height(mm) x Width(mm) x Depth(mm)	84.25mm x 55mm x 24/30mm
Atomizer Head Threading	510
Working Mode	Variable Wattage Mode (V/W) Nickle Temperature Control Mode (Ni T/C) Titanium Temperature Control Mode (Ti T/C) Stainless Steel 314 & 316 Pro Mode VW(Variable Wattage) Mode Memory Mode(M01-M20)
TC Mode Temperature Range	200 - 600°F(100-315°C)
Support Temperature Sensing Coil Material	Ni200/Titanium/Stainless 314/316
TC Mode	0.07-3.00Ω
VW Mode	0.08-3.00Ω
Battery	Removable dual 18650 batteries
Power	5 - 200 w
Voltage	0.35 – 8.00 v
Current	Standby Current : < 300 μA Working Current : the maximum current should be less than 50A when the resistance is 0.1 ohm.

WHAT'S INSIDE

1x VGOD ELITE 200 BOX MOD
1x Carry Case
1x Elite Pin
1x User Manuals

For warranty information, and more information
visit www.officialvgod.com.



 Designed in Torrance
California, USA
officialvgod.com

WARNING

PLEASE READ ENTIRE MANUAL BEFORE OPERATING. ALWAYS TURN OFF DEVICE WHEN NOT IN USE. DO NOT CARRY THE VGOD ELITE 200 BOX MOD IN YOUR POCKETS AS THE DEVICE MAY FIRE. INSPECT THE BATTERIES FOR DAMAGE AFTER EACH USE

VGOD®
ELITE 200

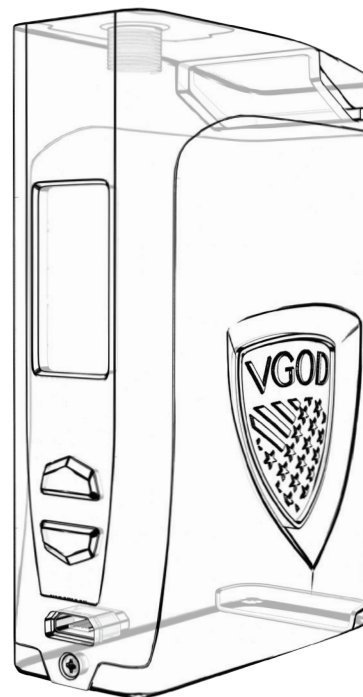
ALWAYS LOCK OR POWER OFF YOUR BOX MOD AFTER USE.



Our customers aren't always the average vapers, You have high standards and we know it. That is why the V GOD team designed this box with you in mind. We want you to have a box that makes a visual and functional statement.

ATTENTION

- Keep the device away from high temperature and humidity.
- Remove the battery from the device when it's not used for a long time.
- Keep the device away from children, minors, and pets.
- Ensure the batteries used in the device are at least 35 Amp, and the insulation wrap is not damaged.

PROTECTION

V GOD is dedicated to producing high performing, reliable and safe products. Integrating safety functions include the following:

1. Atomizers Short Protection
2. System Over-heating Protection
3. Short-circuit Protection
4. Voltage Spike Protection
5. Vaping-time Limit Protection

ATTACHING ATOMIZER

When attaching an atomizer to your ELITE 200, make sure the threads are clean. After a period of use, make sure the mod's female threads and 510 contact pin are free of liquid and dirt.

1. Attach the atomizer to the device making sure it is not on too tight.
2. If using a subohm tank with coilheads, adjust the watts to the recommended range for those heads.
3. If using a dripper (RDA), gen1 (RDTA), or build tank (RTA), adjust the wattage to your desired comfort level.

INSTALLING BATTERIES

The V GOD ELITE 200 chassis features a bottom install battery compartment with a removable sliding door.

1. At the bottom of the mod, press and slide the battery door away from the mod in the direction as indicated by the arrows.
2. Install two (2) High drain 18650 batteries (35A and above ONLY). (-) (+) is indicated inside the individual battery slots. (+) is indicated by RED + and (-) is indicated by BLUE -.
3. Replace the battery door by resting it in place with the door side tabs just before the mod body grooved slots. Press the door towards the batteries and slide close.
4. Press the V GOD fire button 5 times within 2 seconds to power on. The screen will display "V GOD" while loading the chipset.
5. If startup issues occur, contact us at www.officialVGOD.com.

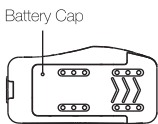
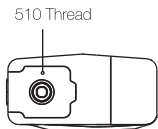
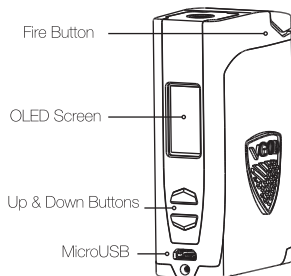

OPERATION

1. Power On/Off: Press the Fire button consecutively 5 times within 2 seconds to power up the mod. The screen will display the "V GOD" while loading the chipset to display the home screen.
2. Vaping Safety Restriction: This device is restricted to fire for 10 seconds consecutively, afterwards it will display "Safety Power Cut". By releasing the fire button, it will reset the 10 second safety restriction.
3. Functions:
 - A. Lock: Press and hold the UP & DOWN Button simultaneously to lock the adjustments to prevent accidental changes.
 - B. Resistance Set: Simultaneously press Fire and DOWN buttons used when attaching an new atomizer or to set the resistance in Temperature Control mode.
 - C. Settings: Simultaneously press Fire and UP button

Use the UP and DOWN buttons to scroll through the menu and the Fire button to change the following:

1. Temperature reading
2. Brightness
3. Invert Screen
4. Rotate Screen
5. Factory Reset
6. Exit

4. Modes:
 - A. Wattage Mode
Press the UP / DOWN Button to adjust the wattage settings.
 - B. Mech Mode: Fires like a mech mod at a continuous 4.2V.
 - C. Pro Mode: Seven (7) second programmable wattage curve. Start high, end low, low to high, or pulse with peaks and valleys.
 1. Simultaneously press and release the UP and DOWN buttons to activate the first programmable second as indicated by the 1st, of 7 bars flashing.
 2. Adjust the wattage to preference with the UP and DOWN buttons and press the Fire button to confirm. Confirmation will move the selection process to the subsequent second bar. In this case the 2nd, second bar will be flashing.
 - a. Repeat step 1, above, until all programmable seconds are complete.
 - b. Simultaneously press and release the UP and DOWN buttons to complete the programming feature.
 - D. Temp Control: Supported coils: Nickel, Titanium, Stainless Steel in 306 and 314
 1. Temperature: Press the UP / DOWN Button to adjust the temperature.
 2. Wattage: simultaneously press and release the UP and DOWN buttons and use UP and DOWN buttons to adjust the wattage.
 3. Resistance Set: Simultaneously press Fire and DOWN buttons to set the resistance in Temperature Control Mode.

ALWAYS LOCK OR POWER OFF YOUR BOX MOD AFTER USE.